



# CAMBRIDGE SECURITY SEALS



## Cable Seal

CAMBRIDGE RESOURCES  
960 ALABAMA AVE  
BROOKLYN, NY 11207  
(877) 922 2538  
INFO@CAMBRIDGESECURITYSEALS.COM

[WWW.CAMBRIDGESECURITYSEALS.COM](http://WWW.CAMBRIDGESECURITYSEALS.COM)

**CAB316CAM**



# CAB316CAM

**CAB316CAM** is an aluminum bodied cable seal that is both CTPAT compliant and ISO 17712 certified as high security.

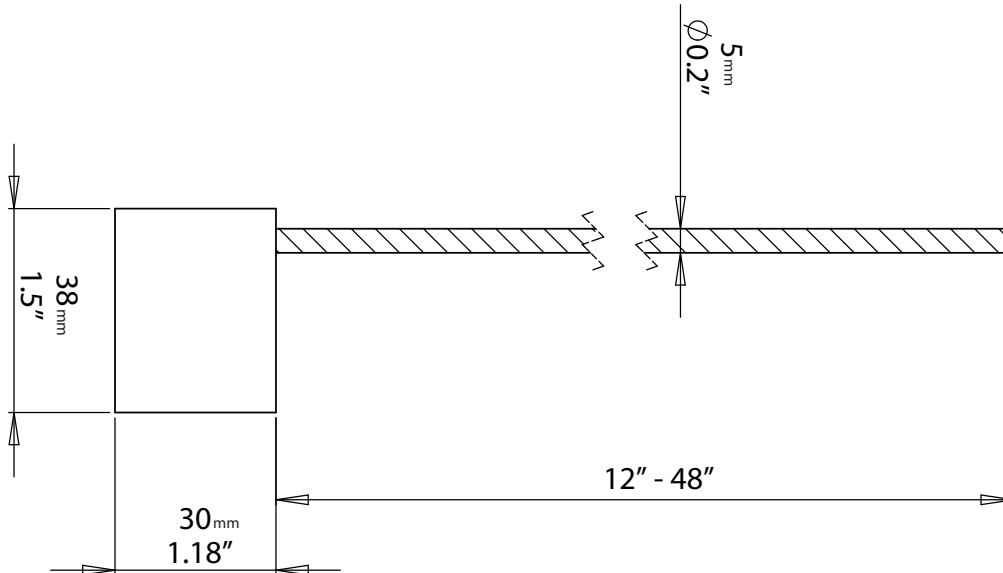

## Features:

- \* Non – preformed galvanized cable unravels when cut to prevent resealing
- \* Self - locking body requires no installation tools
- \* Aluminum body for extended durability
- \* Removal requires cable cutters
- \* Anodized Aluminum bodies insure high visibility and easy readability

## Applications:

- \* Trailer doors
- \* Bulk tankers
- \* Railroad cars
- \* Container doors

## Materials:

- \* Body: Aluminum
- \* Cable: Non-preformed galvanized cable

## Length:

- \* 12" up to 48" available

## Colors:

- \* Red, Blue, Black, Green
- \* Other colors available upon request

## Customization:

- \* Customer name and logo printing (laser)
- \* Available in a variety of lengths
- \* Laser printed with consecutive numbers
- \* Bar coding (laser)
- \* Packaging of seals (bundles, bags)

## Packing:

10 seals per bundle  
200 seals per Master Carton

## Box Dimensions:

**Master Carton**  
16.5" X 8.5" X 8"

## Gross Weight:

**Master Carton**  
31 lbs.

**SHOP ONLINE**



[www.cambridgesecurityseals.com](http://www.cambridgesecurityseals.com)



960 Alabama Ave, Brooklyn, NY 11207  
Ph: (718)927-0009 Fax: (718)485-4403  
[info@cambridgeresources.com](mailto:info@cambridgeresources.com)  
[www.cambridgeresources.com](http://www.cambridgeresources.com)